

7" (3-2-1) (W5770)

Product specification

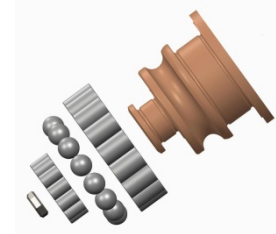
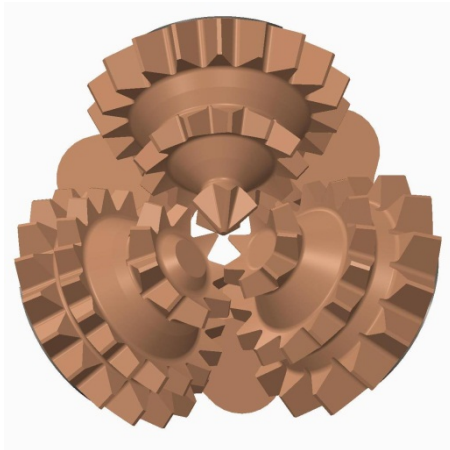

Product Features

- Conventional gage teeth
- 2/3rd Steel tooth standard open bearing bit for medium hard and moderately abrasive formations

Product Specifications

Size / Type	7"	Cutting structure	ST
IADC	3-2-1	Rows	3- Gage / 5 – inner
Pin Connection	3 1/2" API Regular	Teeth count	50– Gage / 65- Inner
Bearing	Ball Roller Friction	Teeth Type	Straight
Circulation type	Centre Flush	Gage Protection	Hard facing
Product weight	17kg	Shirttail protection	2/3 rd Hard facing
Nozzle	-NA-	Shirttail insert	Serrated

Operating parameters

Weight on Bit : 28,000 - 49,000 lbs.
 Rotary Speed (RPM) : 60 – 80 RPM
 Rock UCS : Between 10,000 to 22,500 PSI

Operating parameters are typical ranges and may vary depending on ground conditions